

Creating a continuous, uninterrupted line of beautiful, glare-free LED light, the ELEMENT Merge 1.5 linear system inconspicuously puts light where it is needed without drawing attention to the fixture. The Merge 1.5 patented Capsule Spot Head allows you to simply twist-and-lock adjustable spot heads anywhere along the low-voltage bus channel for stunning design flexibility. The Merge 1.5 Capsule Spot features a simple, tasteful minimalist design that delivers aimable accent or task lighting.

### Key features

- Fully adjustable: 0-35° tilt, 360° rotation
- Capsule Spot Head mounts within the Merge linear channel
- Twist-and-lock design allows LED adjustable spot heads to be placed anywhere along the bus channel

### SPECIFICATIONS

DELIVERED LUMENS	670
WATTS	12
EFFICACY	56 l/w
CRI	90+
CBCP (40°)	1240 (30°)
CCT OPTIONS	2700K, 3000K, 3500K
COLOR CONSISTENCY	3-Step
VOLTAGE	120V or 277V (Concealed 10 gauge, low-voltage bus bar, order 12-volt remote transformer sold separately)
DIMMING	ELV, 0-10V, MLV. Dimming dependant on transformer (see grid for details)
FIELD CHANGEABLE OPTICS	30°, 60°
ADJUSTABILITY	0-35° tilt, 360° rotation
POWER SUPPLY	12VAC
LED LIFETIME	L70; 50,000 hours
WARRANTY*	5 years

\*Visit [techlighting.com](http://techlighting.com) for specific warranty limitations and details.

Maximum number of spots is variable depending on the length of the housing panel; 1 spot per foot of housing panel.

Max run length is 80' for the channel; typical max run length is 40' for the low-voltage bus which can be powered from both sides for a total of 80'; system wattage will impact max run length



## DIMENSIONS

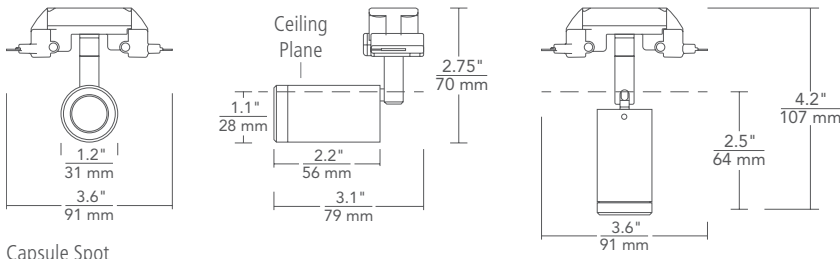

Capsule Spot

## GRIDS

### SPOT HEAD\*

SYSTEM	TYPE	CRI / COLOR TEMPERATURE	FINISH
RLS1	C CAPSULE	927 90 CRI, 2700K 930 90 CRI, 3000K 935 90 CRI, 3500K	W MATTE WHITE
RLS1	C		W

\*TRANSFORMER REQUIRED. CAPSULE SHIPS WITH 30° OPTIC INSTALLED. 60° INCLUDED.

### TRANSFORMERS\* (ORDERED SEPARATELY)

ITEM	DESCRIPTION	DIMMING
700AT060EL	ELECTRONIC, 60W, 120V	ELV
700AT152EL	ELECTRONIC, 150W, 120V	ELV
700AT152ELD010	ELECTRONIC, 150W, 120V	0-10V
700AT150T	MAGNETIC, 150W, 120V	MAGNETIC
700AT150T277	MAGNETIC, 150W, 277V	MAGNETIC
700AT302EL	ELECTRONIC, 300W, 120V	ELV
700AT300T	MAGNETIC, 300W, 120V	MAGNETIC
700AT300T277	MAGNETIC, 300W, 277V	MAGNETIC

DO NOT LOAD TRANSFORMER ABOVE 70% OF RATED LOAD DUE TO IN-RUSH CURRENT. \*CONSULT SPEC SHEETS FOR DIMENSIONS.

## PROJECT INFO

FIXTURE TYPE & QUANTITY

JOB NAME & INFO

NOTES

---



---



---

## PHOTOMETRICS: MERGE

DESCRIPTION: Merge LED Capsule Spot  
30° Optic, 90 CRI, 3000K

MODEL: RLS1C930W

INPUT POWER (WATTS): 11.9

INPUT POWER FACTOR: .91

ABSOLUTE LUMINOUS FLUX (LUMENS): 668.5

LUMEN EFFICACY (LUMENS PER WATT): 56.2

ANGLE	0°	45°	90°
0°	1240	1240	1240
5°	1197	1173	1172
10°	988	957	964
15°	716	700	714
20°	492	478	491
25°	322	310	318
30°	205	200	207
35°	138	135	142
40°	98	97	102
45°	72	70	75
50°	53	52	56
55°	40	39	42
60°	30	29	31
65°	22	21	22
70°	15	14	14
75°	10	9	9
80°	6	6	6
85°	3	3	3
90°	0	0	0

