

Creating a continuous uninterrupted line of beautiful, glare-free LED light, the ELEMENT Merge 3.0 recessed linear system inconspicuously puts light where it is needed without drawing attention to the fixture. The continuous line aesthetic created by the ELEMENT Merge 3.0 system is enhanced using either a specifically engineered 90° turn connector or wall-to-ceiling connector. Lines of LED light (also available with an RGB option) can be designed to seamlessly make 90° same-plane turns or transition from ceiling to wall for enhanced design interest while also allowing the option to add spot heads for accent and task lighting, all without adding more light fixtures to the space.

### Key Features:

- Optional illuminated 90° horizontal (same plane) transitions (not available in Lay-in)
- Low profile design for use in 2x6 construction
- Dual sided illumination for even light along the channel
- 3-Step or better color binning on all non-RGB options
- Internal reflector finished with high reflectance matte white paint for even light distribution & optimal efficiency

### SPECIFICATIONS

DELIVERED LUMENS	2000 lms/ft or 1400 lms/ft
WATTS	28 or 18
EFFICACY	71 l/w or 78 l/w
CRI	80+, 90+ & RGB
CCT OPTIONS	2700K, 3000K, 3500K, or Programmable White (2700K-4000K), RGB
VOLTAGE	120V or 277V (Concealed 10 gauge, low-voltage bus bar, order 12-volt remote transformer sold separately)
DIMMING	ELV, 0-10, DMX, Hi-Lume
TRANSITIONS	Illuminated 90° horizontal turns (same plane) transitions (not available in Lay-in)
CEILING APPEARANCE	Flanged or Flangeless
CEILING APERTURE	3" beveled
HOUSING	IC Airtight available in 2', 4', 6' and 8'. IC suitable up to R60 spray foam insulation (Consult factory for Chicago Plenum).
POWER SUPPLY**	Constant Current (Each linear channel includes a self-contained ELV, 0-10V, Lutron Hi-Lume 2 Wire PWM (120V only) or Lutron Hi-Lume, Eco System Fade-to-Black Driver, DMX driver for RGB), 0-10V 1%, 0-10V 0.1%
CONSTRUCTION	Housing: 20 gauge sheet metal Extrusion: Aluminum
HARDWARE	Steel
FINISH	White Powder Coat
GENERAL LISTING	ETL
CALIFORNIA TITLE 24	Registered CEC Appliance Database. Can be used to comply with CEC 2016 Title 24 Part 6 (Static White, 90 CRI versions).
LED LIFETIME	L70; 50,000 hours
WARRANTY*	5 years

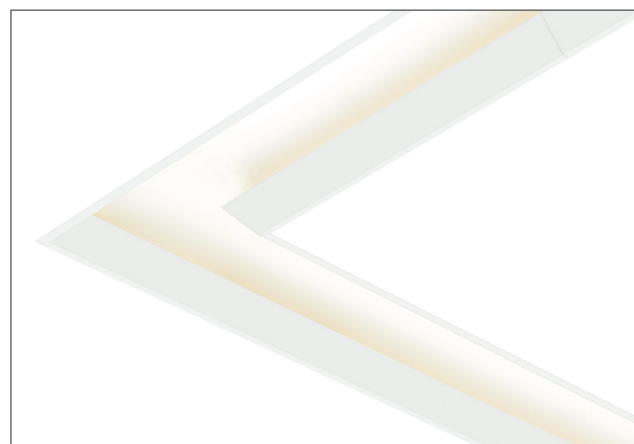

MERGE  
shown flanged

\*Visit ELEMENT-lighting.com for specific warranty limitations and details.

\*\*Consult Quotes Department for additional driver options.

Max run length is 80' for the channel; typical max run length is 40' for the low-voltage bus which can be powered from both sides for a total of 80'; system wattage will impact max run length

## DIMENSIONS

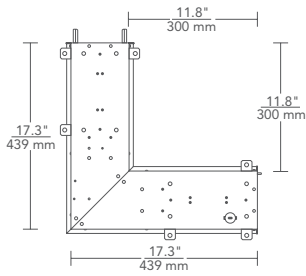

Flanged 90° L connector (top view)

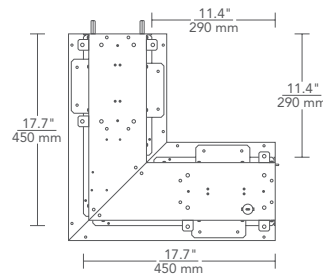

Flangeless 90° L connector (top view)

## GRIDS

SYSTEM	TYPE	OUTPUT	CEILING APPEARANCE	CRI / COLOR TEMPERATURE	FINISH	CONTROLS	VOLTAGE	
RLS3	L	"L" CONNECTOR	RF RECESSED FLANGED	827 80 CRI, 2700K	W MATTE WHITE	ELV STANDARD ELV	1 120 VOLT	
	LPF	"L" CONNECTOR WITH POWER FEED†	RL RECESSED FLANGELESS	830 80 CRI, 3000K		O10 0-10V DIMMING	2 277 VOLT	
	WTC	WALL-TO-CEILING				835 80 CRI, 3500K	ELD0 ELDOLED 0.1% 0-10V LINEAR LOGARITHMIC	
						927 90 CRI, 2700K	ELD0A ELDOLED 0.1% 0-10V LOGARITHMIC	
						930 90 CRI, 3000K	ELD1 ELDOLED 1% 0-10V LINEAR	
						935 90 CRI, 3500K	ELD1A ELDOLED 1% 0-10V LOGARITHMIC	
						82740 80 CRI, PROGRAMMABLE WHITE*	HL2W LUTRON HI-LUME 2 WIRE/PWM***	
						RGB RGB**	HLECO LUTRON HI-LUME ECO-SYSTEM FADE-TO-BLACK	
							DMX DMX CONTROL	

### RLS3

### W

\*0-10 VOLT DIMMING ONLY. \*\*DMX CONTROL ONLY. \*\*\*HL2W – TWO WIRE LOW-VOLTAGE ELECTRONIC DIMMING, 120 VOLT ONLY. †"CLOSED" CONFIGURATION REQUIRE CONNECTOR WITH POWER FEED.  
 †1000 LMS/FT ONLY AVAILABLE IN STATIC WHITE & WITH STANDARD ELV AND 0-10V DRIVERS.

## PROJECT INFO

FIXTURE TYPE & QUANTITY	JOB NAME & INFO	NOTES

**ELEMENT**  
by Tech Lighting®

GENERATION BRANDS  
 7400 Linder Avenue, Skokie, Illinois 60077  
 T 847.410.4400 F 847.410.4500



© 2017 Tech Lighting, L.L.C. All rights reserved. The "Tech Lighting" graphic is a registered trademark of Tech Lighting, L.L.C. Tech Lighting reserves the right to change specifications for product improvements without notification.